

# WWI 66 PROFILE SERIES

Wall-Wash / Indirect

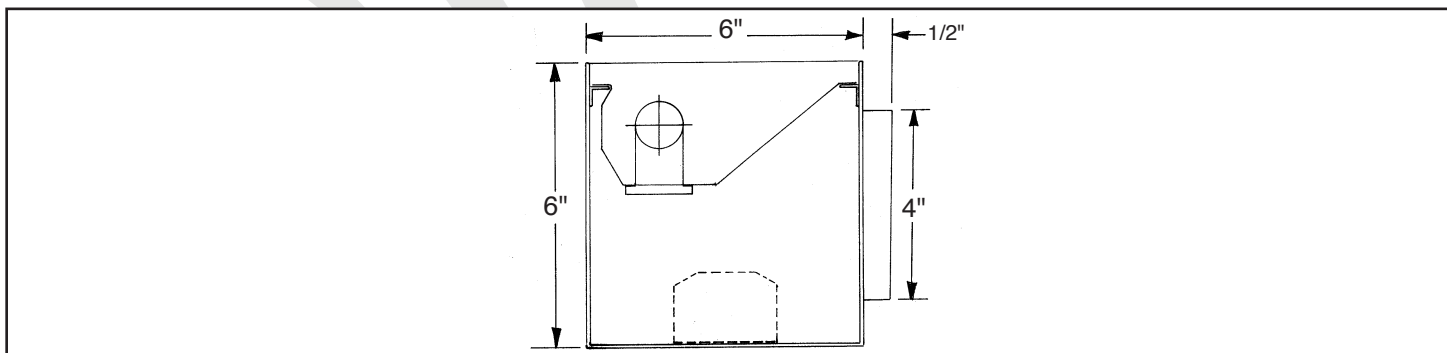

## ORDERING DATA

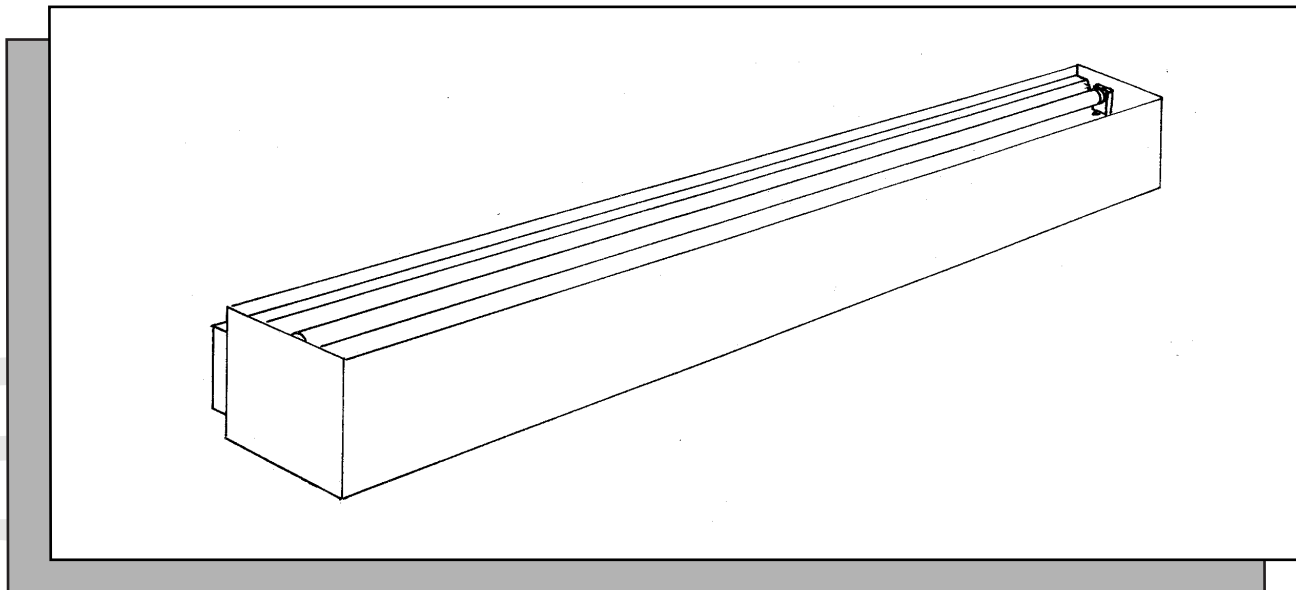
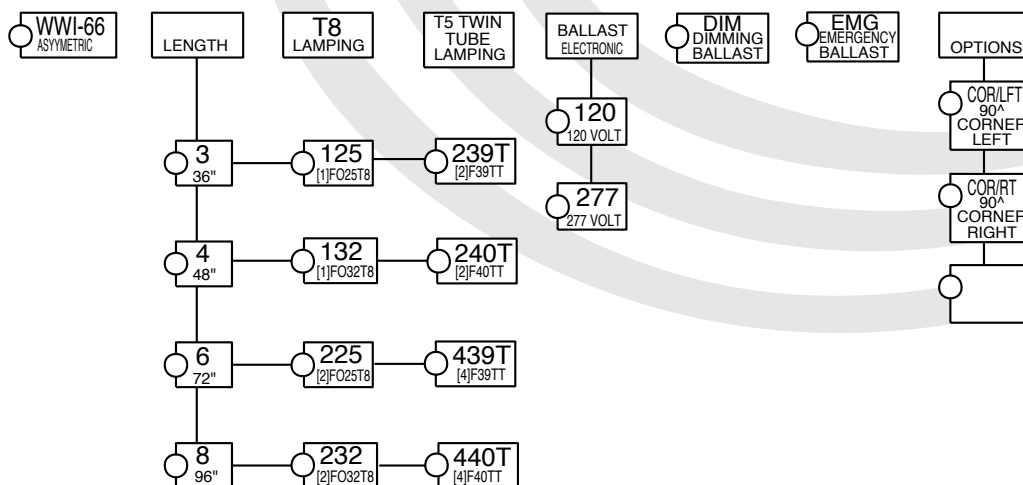

# Specifications

**DESCRIPTION:** High efficiency, high visual comfort, and attractive appearance make it ideal for architectural spaces. Rectilinear shape and wall/ceiling washing make this a versatile lighting instrument. Fixture is commonly used for small offices, chalkboards, telephone kiosks, and retail spaces.

**HOUSING:** Precision die formed 20 gauge cold rolled steel. Welded construction for rigidity. The socket plates and ballast cover are easily accessible for servicing. Surface mounted

**OPTICS:** Indirect ceiling wash uses an asymmetrical full specular aluminum anodized reflector system. Consult factory for options not listed.

**BALLAST:** Electronic T8 or Twin Tube 40w. Class "P". CBM-ETL certified. Consult factory for magnetic T12 ballast

**FINISH:** All steel parts are treated with the HASCO "Perm-O-Last" multi-stage rust inhibitive process. Standard finish is a durable baked white enamel with a minimum reflectance of 90%. Consult factory for other colors and finishes. Fixture is post painted.

**LABELING:** All HASCO fixtures are U.L. approved and IBEW union made.

## PHOTOMETRICS: WW I 66 PROFILE SERIES Wall-Wash Indirect COEFFICIENTS OF UTILIZATION, ZONAL CAVITY METHOD EFFECTIVE FLOOR CAVITY REFLECTANCE 0.20

CEILING WALL RCR	80				50			30		
	70	50	30	10	50	30	10	50	30	10
0										
1	71	71	71	71	40	40	40	23	23	23
2	63	59	57	54	35	34	33	20	19	18
3	52	48	41	37	30	28	27	17	16	15
4	48	40	35	31	27	24	22	15	14	13
5	44	35	30	26	23	21	19	12	10	9
6	40	31	25	20	21	18	16	10	9	7
7	37	28	23	19	16	13	11	9	7	7
8	34	25	19	16	15	12	10	8	7	6
9	31	24	17	14	13	10	8	7	7	4
10	29	21	17	12	13	9	7	7	7	2

**Luminaire: Formed Steel**  
**Ballast: Valmont E232P1120G01**  
**Lamping: [2] F32T8 @2900 lumens**  
**Mounting: Pendant**

**HASCO File # 101865/ITK**  
**Prepared by: P. Marshall**  
**Catalog number: WWI66-4-232-120**

**Data subject to change**  
**Please consult factory for**  
**additional information.**

ISO CURVE

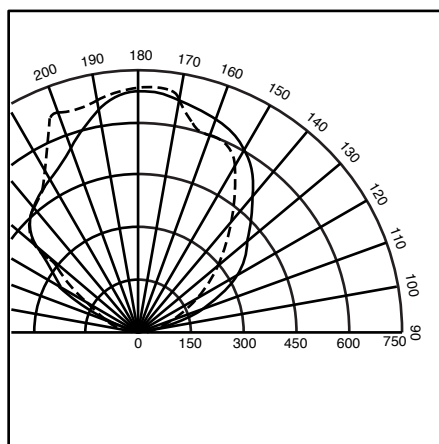

CANDLE POWER SUMMARY

VERT ANGLE	0	90
90	3	0
100	33	35
110	74	208
120	168	331
130	285	419
135	344	481
140	408	532
150	534	603
160	618	648
170	671	684
180	695	695
190	668	664
200	536	546
210	508	526
220	472	508
225	465	482
230	346	403
240	251	302
250	182	175
260	74	56
270	3	2

ZONAL LUMEN SUMMARY

ZONE	LUMENS	%LAMP	%FIXTURE
180-90	2150	73.88	100
90-0	2456	42.5	89.20
180-0	2150	73.88	100